

Hinge, Filling lid

Volvo S60 (-2009), S80 (-2006), V70 P26, XC70 (2001-2007), XC90 (-2014), 850, 740, 760, 780, 940, 960, S90, V90 (-1998)

Note on handling the cast-on rivet pins on the hinge for the tank flap.

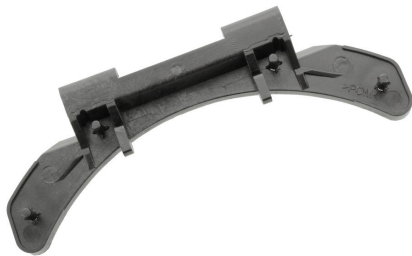

On delivery, the rivet pins are cast-on the hinge.



The rivet pins must be broken off with a pair of needle nose pliers.



To do this, use a pair of needle-nose pliers and break off the rivet pins as shown.

Important: Keep the rivet pins !!



Now turn the rivet pins through 180 degrees.



Insert the turned rivet pins into the hinge with the top side. Now the hinge can be mounted as usual.